

All-New UA series

UA432L

綠能三機一體線馬驅動線切割機

GREEN & Compact Linear Wire Cut EDM



-20%

全新三機一體設計，可較傳統機型少20%。

Newly designed compact Wire Cut EDM, the floor space is 20% less than traditional type.

-18%

第六代自動穿線系統AWT，剪線時耗電量節省18%。

The 6th generation AWT can reduce threading power consumption by 18%.

-42%

內建綠色加工模式，銅線消耗降低42%。

Eco Cut mode reduces wire consumption by 42%.

24"

全新W5N控制器配備24"觸控螢幕，選配RFID讀取器或條碼掃描器。

The new W5N controller is equipped with 24" touch screen and optional RFID or barcode reader.

-40%

高效節能管理系統HEMS，整體加工能耗下降了40%。

Through power energy-saving system and water system energy-saving solution, overall processing energy consumption has decreased by 40%.

UX1

XY搭載最新一代UX1線性馬達，無磨耗背隙問題、降低維護成本、提升使用壽命等優勢，加工精度優於螺桿傳動。

Newest In-house UX1 linear motor features no frictions, backlash-free, decreases the maintenance costs, prolongs life-span, and obtains greater accuracy than ball-screw drive.

10x

導入Linux系統架構GenOS作業系統，運算效能增加10倍以上。

運用EtherCAT自動控制技術，具備高速反應及高擴充性，滿足高性能的多軸同步運動控制之需求。

The new GenOS is based on Linux operation system. The computing performance is 10 times faster.

Utilizing EtherCAT technology features high-speed response and high scalability to meet the requirements of simultaneous multiple axes motion control.

UA series

All-New UA series

綠能三機一體
線馬驅動線切割機

Green and Compact
Linear-Driven
Wire Cut EDM

佔地面積圖

Installation
Dimension

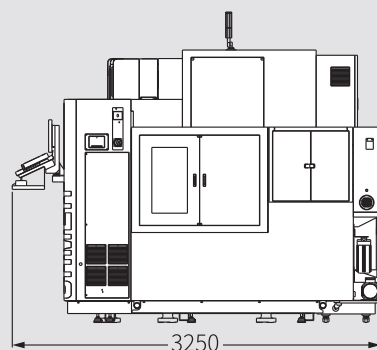
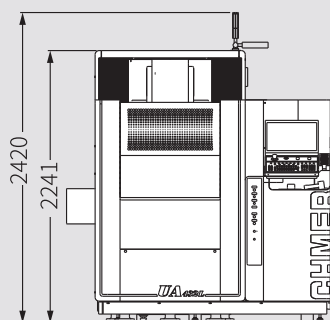
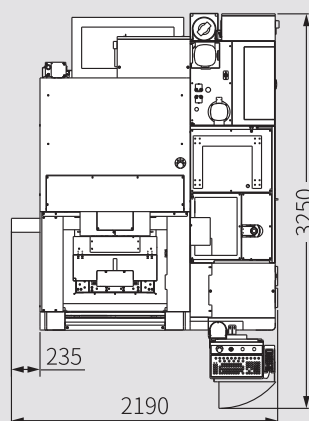

技術資料

Technical Specifications

機台規格	Machine Specifications	單位 / Unit	UA432L	UA643L
X、Y、Z 行程	X, Y, Z axes Travel	mm	400 x 300 x 250	600 x 400 x 300
U、V 行程	U, V axes Travel	mm	100 x 100	120 x 120
最大工件尺寸	Max. Workpiece Dimensions	mm	W800 x D600 x H245	W900 x D650 x H295
最大工件重量	Max. Weight of Workpiece	kg	550	700
X、Y 進給速度	X, Y-axis Feed Rate	mm/min	1800	1800
軸驅動系統	Driving System		XY 軸線性馬達 / UVZ 軸 AC 伺服馬達 XX, Y Linear Motors Z, U, V AC Servomotors	
線經 (標準)	Wire Diameters (Standard)	mm	Ø0.15~Ø0.3 (Ø0.25)	
線張力	Wire Tension	gf	300 ~ 2500	
最大送線速度	Maximum Wire Speed	mm/sec	300	
供線輪負重	Wire Load Capacity	kg	8	
最大切割斜度	Maximum Taper Angle	°/mm	± 21°/100(廣角噴嘴, DA+DB=15mm)	
外觀配置圖	Machine Dimensions	mm	W2190 x D3250 x H2420	W2430 x D3800 x H2440
淨重	Machine Weight	kg	2700	4000
過濾系統		Dielectric Filtration System		
過濾容量	Dielectric Tank Capacity	L	850L	1080L
過濾方式	Filtration	Type	紙濾網 / Paper filters	
離子樹脂過濾器	Ion Exchange Resin Filter	L	14L	
水質控制	Dielectric Quality Control		自動 / Auto	
液溫度控制	Dielectric Temperature Control		自動 / Auto	

※本公司隨時在進行研究改進的工作，因此保有隨時更改設計、規格尺寸及機械結構之權利



慶鴻機電工業股份有限公司

408 台中市南屯區精科一路三號 (精密機械園區)

TEL : +886 4 2350 9188 E-Mail : overseas@mail.chmer.com

